

- NOTES:**
1. INSTALLATION SHALL COMPLY WITH ALL APPLICABLE NATIONAL, STATE, AND LOCAL CODES.
 2. PLEASE REFER TO PRODUCT DOCUMENTATION FOR FURTHER INFORMATION.
 3. UNLESS OTHERWISE SPECIFIED, ALL DIMENSIONS ARE IN INCHES [MILLIMETERS].
 4. NET WEIGHT IS 5.00 LBS [2.27 KG]
 - △ 5. LENGTH OF CORD IS 78.00 INCHES [1982 MILLIMETERS]



TITLE:
RACK PDU, SWITCHED, 1U
INPUT: 230VAC, 15A MAX, IEC-320 C14
OUTPUT: 230VAC, 10A, (8) IEC-320 C13
OUTPUT: 208VAC, 12A, (8) IEC-320 C13
GENERAL MECHANICAL LAYOUT

PROJECT: SUBMITTAL DRAWINGS SHEET 1 OF 2

AS-108-C13-15A-C14

END VIEW

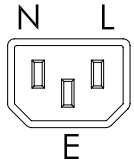

IEC-320 C14

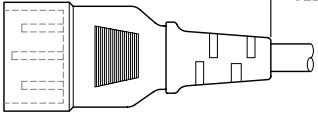

SEE NOTE 5 ON SHEET 1

END VIEW

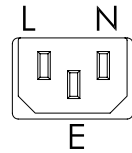

IEC-320 C13

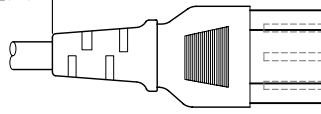

DETAIL D
INPUT CORD PLUG DETAIL

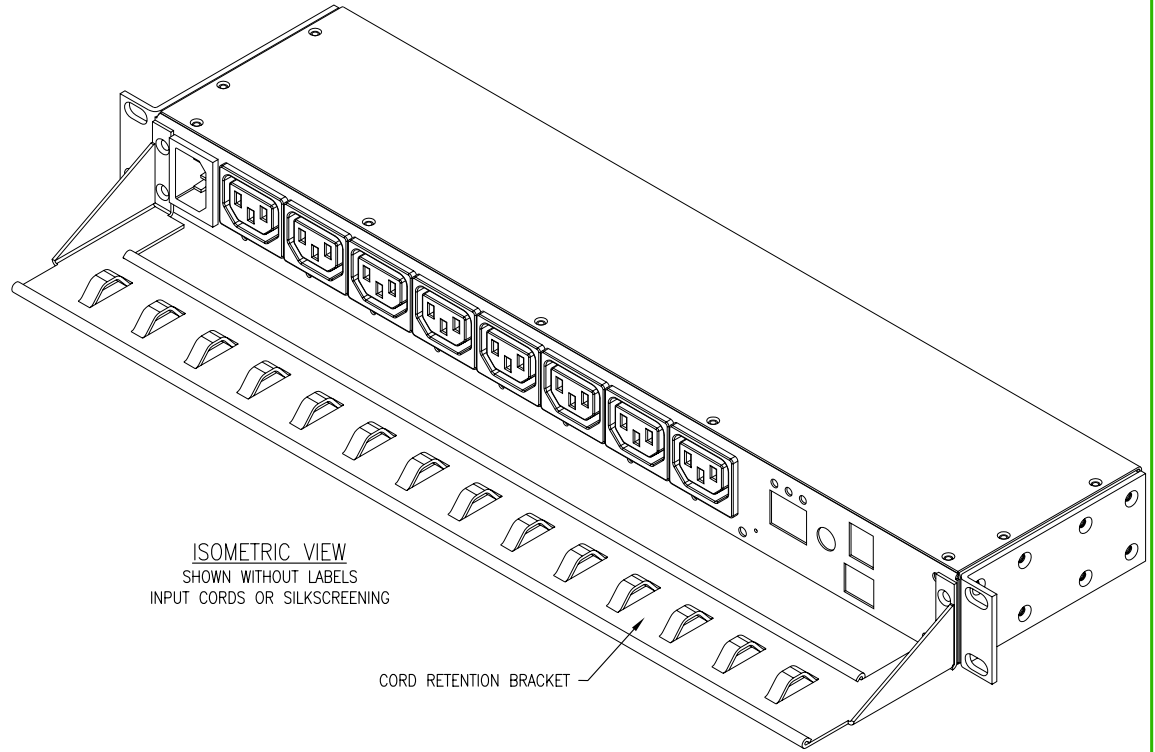

ISOMETRIC VIEW
SHOWN WITHOUT LABELS
INPUT CORDS OR SILKSCREENING

CORD RETENTION BRACKET

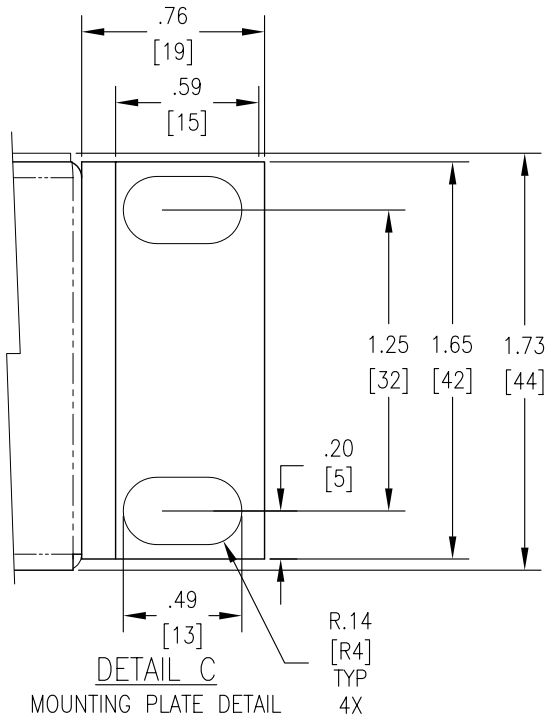

DETAIL C
MOUNTING PLATE DETAIL

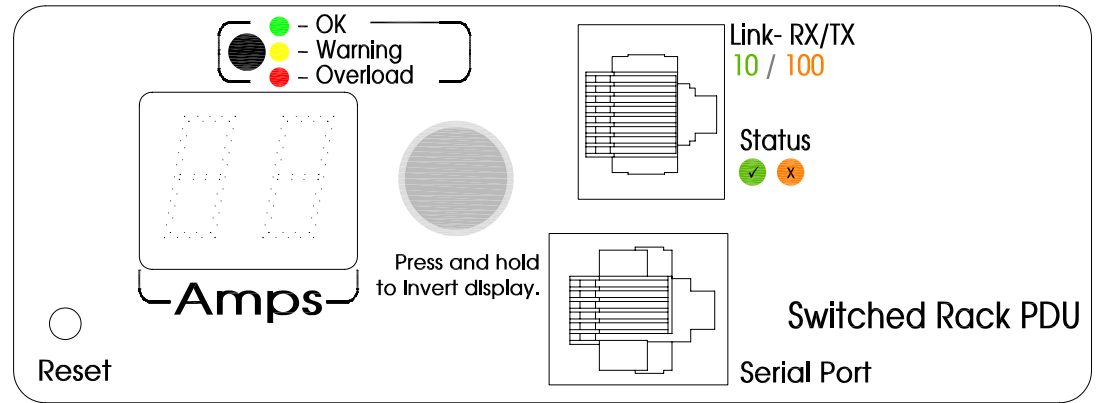

DETAIL B
DISPLAY INTERFACE
(ENLARGED)